

# SOUTH ROAD SUPERWAY TRAFFIC CHANGES

## Changes to South Road 5 - 7 April 2013

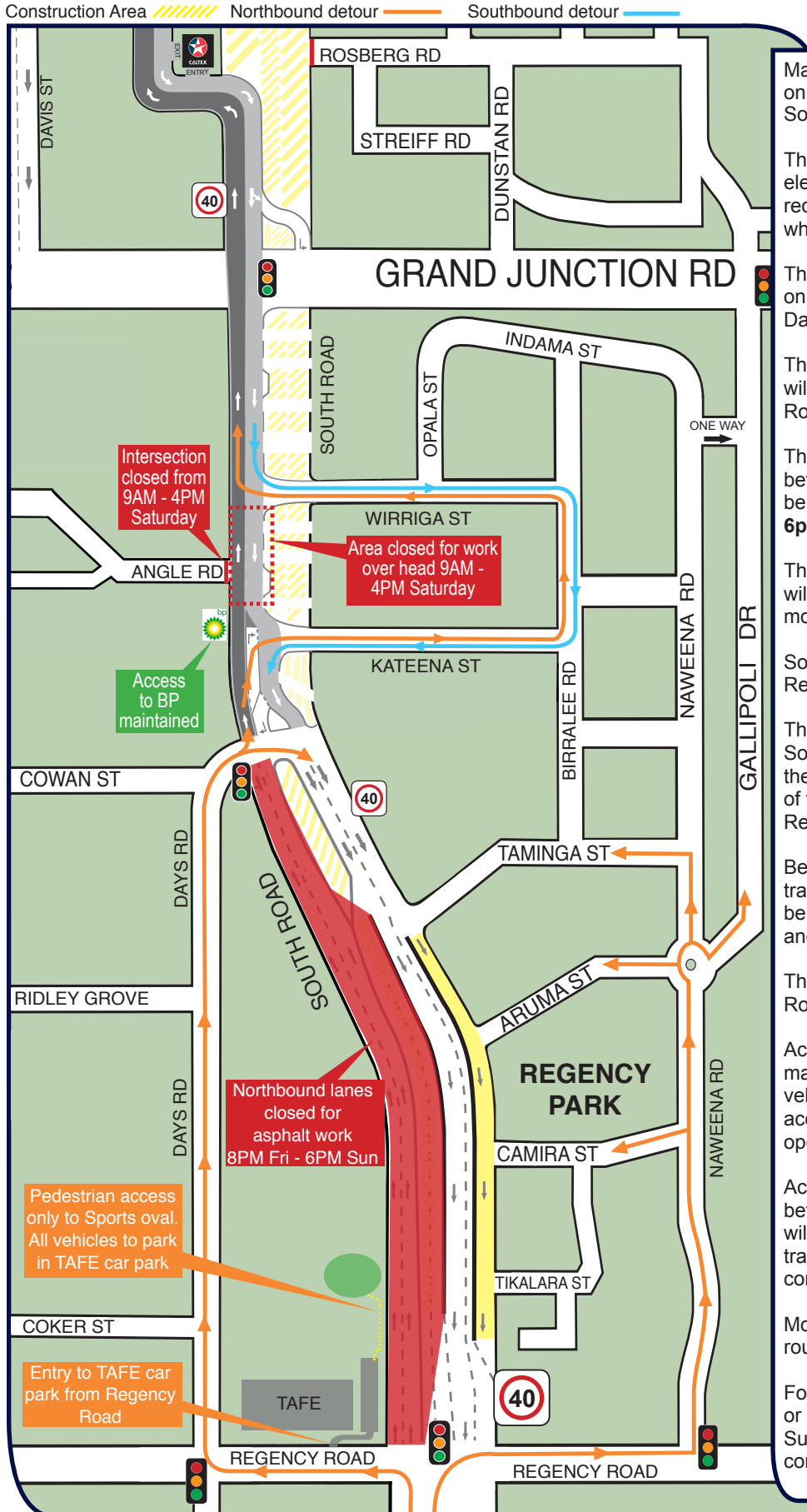

Major roadwork activity will be undertaken on South Road this weekend as part of the South Road Superway construction.

This work includes joining two spans of the elevated roadway near Angle Road which requires an exclusion zone underneath where the work is taking place.

The final layers of asphalt will also be placed on the northbound carriageway between Days Road and Regency Road.

These are major construction activities and will require traffic to be detoured from South Road.

The northbound lanes on South Road between Regency Road and Days Road will be **closed from 8pm on Friday 5 April until 6pm Sunday 7 April**.

The left turn from South Road to Days Road will be closed, however all other turning movements will be open.

Southbound lanes between Days Road and Regency Road will be open.

There is no vehicle access to the oval on South Road during this time. All visitors to the oval should park in the adjoining car park of the Regency Park TAFE (access is from Regency Road only) and walk to the oval.

Between **9am and 4pm on Saturday** all traffic on South Road near Angle Road will be diverted to Wurriga Street, Birralee Road and Kateena Street.

The intersection of Angle Road and South Road will be closed.

Access to the BP Service Station will be maintained from South Road with exiting vehicles directed to Kateena Street. The access from the BP to Angle Road will be open.

Access to businesses on South Road between Wurriga Street and Kateena Street will be maintained with the assistance of traffic controllers. Please approach a traffic controller if access is required.

Motorists are encouraged to seek alternative routes during the weekend to avoid delays.

For more information about this work or any other aspect of the South Road Superway, please call **1300 638 789** or email [contactus@urbansuperway.com.au](mailto:contactus@urbansuperway.com.au)

\* This map is indicative only and not to scale



Urban Superway, comprising John Holland Pty Ltd and Leed Engineering and Construction Pty Ltd, is the design and construction contractor delivering the \$842 million Australian and South Australian government funded South Road Superway with the Department of Planning, Transport and Infrastructure.

# SOUTH ROAD SUPERWAY TRAFFIC CHANGES

## Changes to South Road 5 -7 April 2013



Construction Area Northbound detour Southbound detour

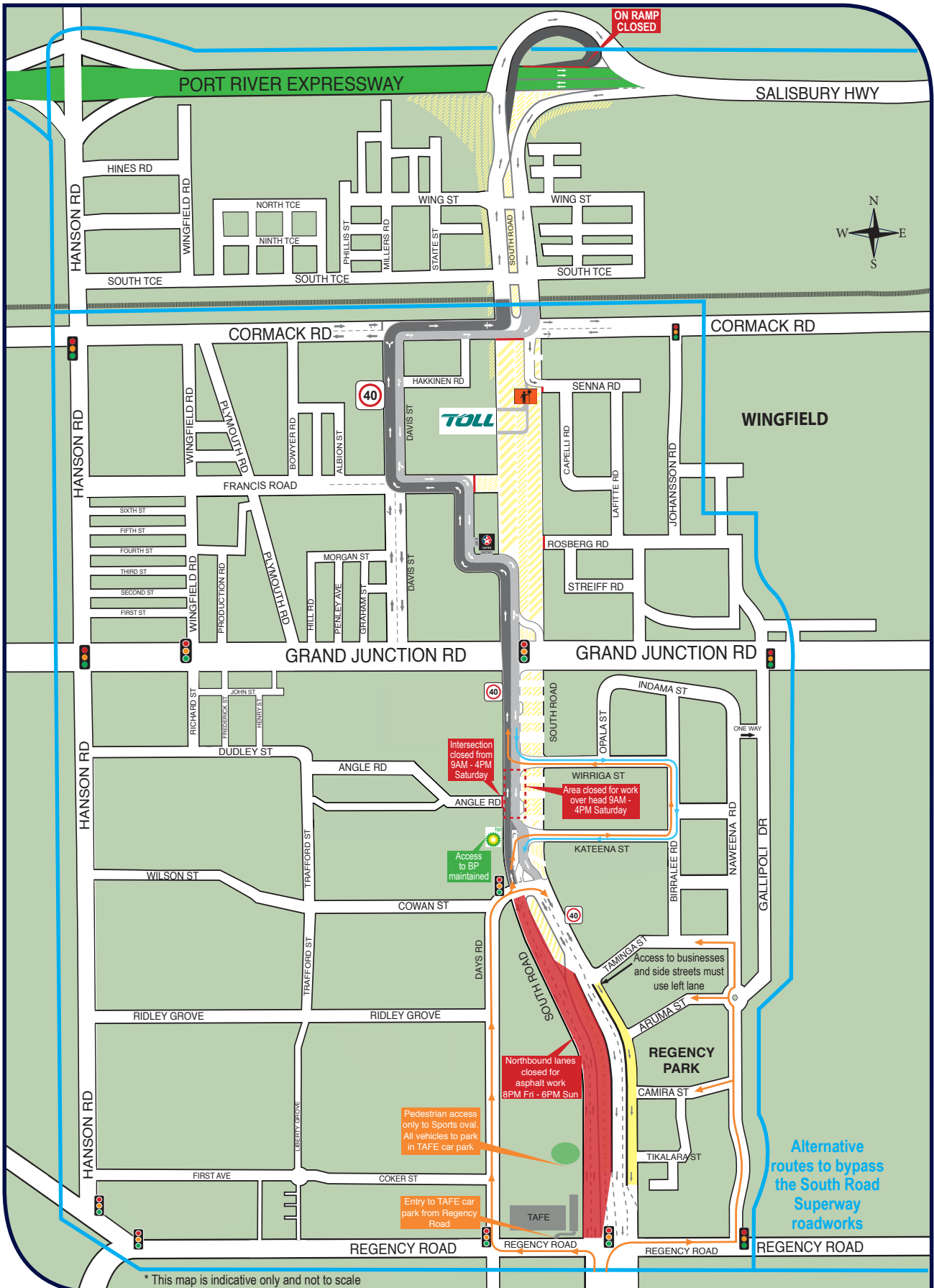

\* This map is indicative only and not to scale



Urban Superway, comprising John Holland Pty Ltd and Leed Engineering and Construction Pty Ltd, is the design and construction contractor delivering the \$842 million Australian and South Australian government funded South Road Superway with the Department of Planning, Transport and Infrastructure.